



## SUCTION SYSTEM CHECKLIST

It is recommended that suction systems are checked **at least** every 7 days

### Do's

- Ensure suction controller is connected to the liner.
- Ensure taper connector is a firm fit in the liner port.
- Ensure liner bag is fully inflated.
- Turn on controller and set to maximum.
- Occlude patient port with finger.
- Check suction rises on gauge above - 400mm/hg (-50Kpa).
- Release finger and listen for air flow.
- Turn down controller to mid range.
- Turn off controller and refit patient catheter tubing (as appropriate).
- Check condition of regulator filter and replace according to manufacturers recommendations.

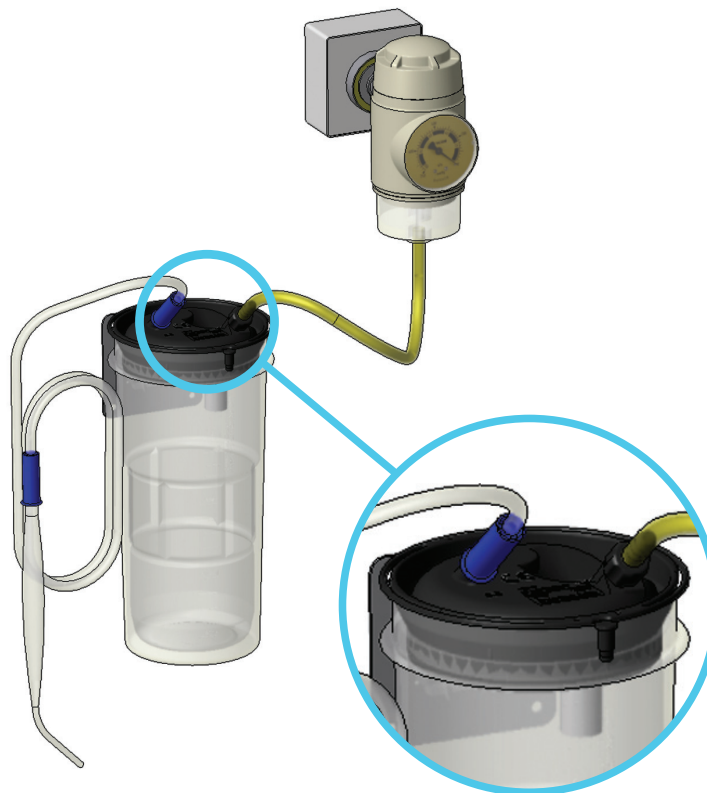

### Don'ts

- Leave liner “folded” in canister.
- Use the incorrect size liner for the canister.
- Use liners past their use by date.
- Use liners that are damaged, split, broken etc.
- Leave contaminated liners in-situ.
- Attempt to reuse liners.
  - they are single use!
- Place equipment in inaccessible positions.
- Leave vacuum “on” when not in use.

### VacSax Limited

Western Wood Way, Langage Science Park,  
Plymouth, PL7 5BG United Kingdom

T +44(1752) 337 000 F +44(1752) 337 600

[www.vacsax.com](http://www.vacsax.com)